

## Your Responsibility

As a business operator or property owner, you may have responsibilities under:

### 1. Local government bylaws

Your municipality or the CRD may have stormwater-related bylaws that include:

- prohibiting all business waste and other specific prohibited wastes from entering the storm drain system and local waterways
- catch basin maintenance, inspection and record-keeping requirements
- spill response plans
- protection of natural water courses, ditches and stormwater drainage system
- codes of practice for specific business sectors

Also, Bylaw 4168 applies specifically to all businesses on the Saanich Peninsula. This bylaw helps protect streams, lakes, and marine shorelines from pollution by prohibiting domestic, commercial, and industrial contaminants from entering stormwater drainage systems. It includes codes of practice for parking lots and outdoor storage of materials or equipment.

### 2. Other jurisdictions

**Emergency Management BC** is responsible for responding to spills of any hazardous/harmful substance (oils/grease, gasoline, paints/solvents, mechanical fluids, soils, etc.) in any quantity that may impact the environment.

Any person responsible for a stormwater drainage system contamination may be held liable under the following environmental legislation:

- federal *Fisheries Act*
- BC Hazardous Waste Regulation
- BC *Environmental Management Act*
- BC *Water Sustainability Act*

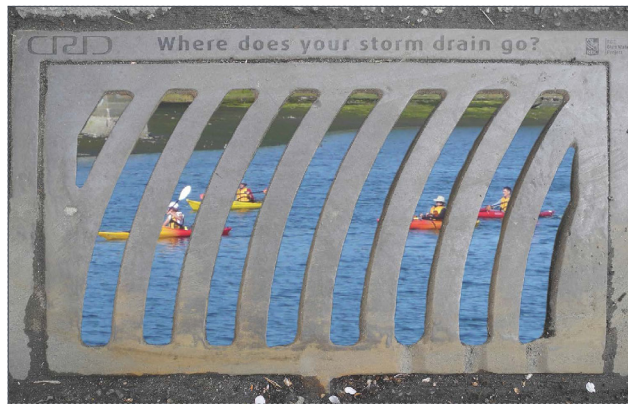

## Be a Watershed-wise Business

Watershed-wise businesses ensure contaminants in stormwater runoff stay out of storm drain system, local waterways and marine shorelines.

### Learn More

To learn more about being a watershed-wise business, visit:

- [www.crd.bc.ca/Bylaw4168](http://www.crd.bc.ca/Bylaw4168)
- [www.crd.bc.ca/catchbasin](http://www.crd.bc.ca/catchbasin)
- [www.crd.bc.ca/clw](http://www.crd.bc.ca/clw)
- [www.crd.bc.ca/watersheds](http://www.crd.bc.ca/watersheds)

To find a list of service providers, visit:  
[www.crd.bc.ca/tlwdirectory](http://www.crd.bc.ca/tlwdirectory)



Making a difference...together

**Capital Regional District**  
Environmental Protection  
625 Fisgard Street  
Victoria, BC V8W 1R7  
250.360.3253

**In the event of a spill, contact:**

**1. Emergency Management BC:**  
**1.800.663.3456 (available 24/7)**

**2. Local government contacts:**  
**[www.crd.bc.ca/report-spill](http://www.crd.bc.ca/report-spill)**

For Business

# Catch Basin Maintenance

**CRD** | Environmental Services



**Reduce your environmental liability by preventing stormwater contamination**

## What is a Catch Basin?

Catch basins are chambers, usually with grates as covers, that collect stormwater and provide some contaminant removal by allowing solids to settle and light debris to float. These units discharge to storm drain systems and then to nearby water bodies, such as streams, wetlands or marine shorelines. Catch basins are common in parking lots and on streets. They may also be called “stormwater rehabilitation units.”

When maintained and serviced properly, catch basins effectively reduce the amount of contamination leading to our waterways, beaches, habitats and marine shorelines.

## Cross-Section of a Catch Basin

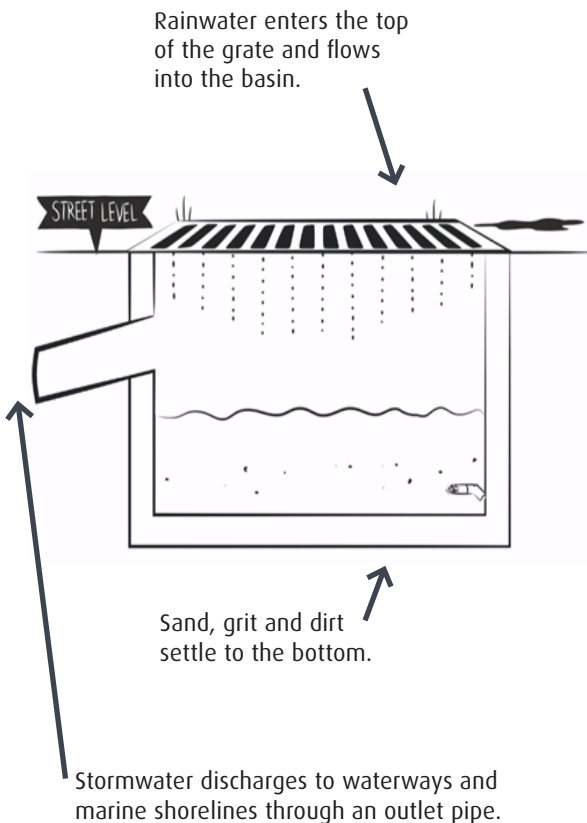

## Best Management Practices

As the property owner, you are responsible for maintaining your catch basin. To prevent contaminants from entering the stormwater drainage system and to prevent clogging, which may lead to flooding and property damage, you can follow these simple practices:

- Inspect your catch basin twice per year and record your findings. Make observations on the amount of solids collected in the basin. If the solids are more than halfway to the outlet pipe, it's time to clean it out.
- Sweep any leaves, garbage and debris away from the grate to ensure it does not block the flow of stormwater.
- The best time of year to clean out a catch basin is right before the fall rains start in September or October. This ensures the unit will function properly to direct stormwater away from your property.
- Be sure to keep records of inspection and maintenance. Your municipality may have a bylaw that requires record keeping.
- If the catch basin smells of oil or gasoline, or if there is an oily sheen on the surface of the water, it should be cleaned out and the water and/or sediment may have to be managed as **hazardous waste**. Contact the CRD or a service provider to discuss your options.
- Hire a qualified company to pump out your catch basin.
- Keep a spill kit on hand in case of emergency spills.

## Did You Know?

As a watershed-wise business, you're helping to keep our local water bodies clean by preventing stormwater contamination at its source.

If you own a property with a parking lot, it likely contains a catch basin. As the property owner, you are responsible for maintaining the unit.

If not properly maintained, catch basins can clog with debris, causing flooding of a parking lot or road and pollution downstream.

Your municipality may have bylaws that require regular catch basin maintenance and inspection. Contact your local municipal office for more information.

*A clogged catch basin can cause flooding on your parking lot. Check up on yours regularly.*

A simple spill kit (shown below) can be found at local safety supply hardware stores.

